

Erickson Roed & Associates

Structural Engineers

2550 University Avenue West
Suite 201-S
Saint Paul, MN 55114

Phone: 651-251-7570 Fax: 651-251-7578

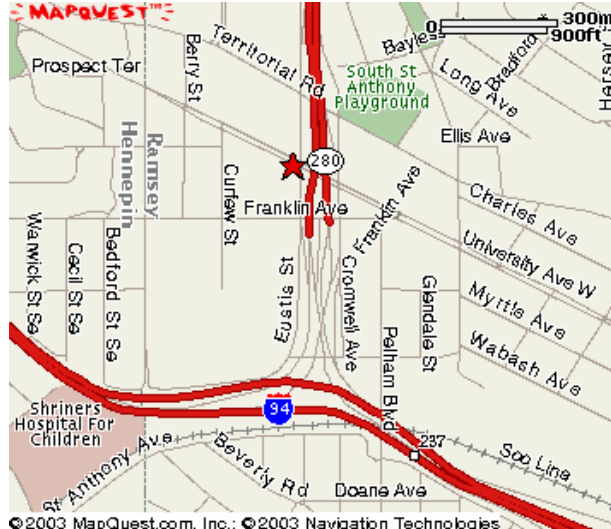

East / West bound:

From I-94, take the University / 280 Exit (only goes north). EAST bound traffic note that your 280 Exit is off the LEFT Lane. Follow the signs for University Avenue, do not actually merge onto 280. At the first set of lights (Franklin Ave.), turn left (west) and proceed over the top of 280. The upper parking deck entrance is on the right, just before the building.

South bound:

From 280, take the Territorial Rd. / University Ave. exit. Continue through the first two sets of lights, crossing Territorial, then University. Drive past Court International, turn right (west) at the third set of lights (Franklin Ave.) and right again onto the upper parking deck.

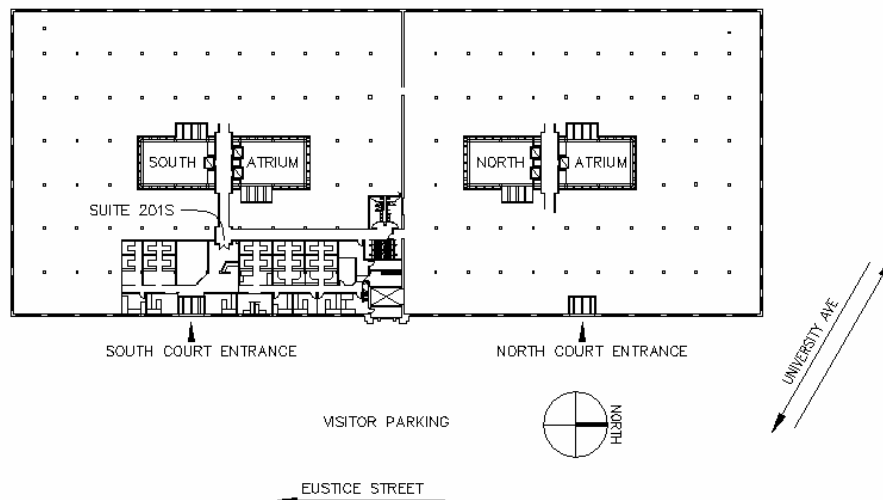

Use the South Court entrance and take an elevator to the Second Floor. Suite 201-S is located off the main corridor, on the East side of the building.